



MADE GOODS

CONRAD FREESTANDING VANITY

Our faux raffia Conrad furniture collection—a Made Goods favorite—has expanded to include freestanding and floating bathroom vanities with the same expertly crafted cabinetry and meticulous attention to detail.



Shown: Pristine Faux Raffia

Vanity Base/Drawer Interior:



Pristine Faux Raffia/
Light Wood Veneer



French Gray Faux Raffia/
Light Wood Veneer



Off-White Faux Raffia/
Light Wood Veneer



Seal Faux Raffia/
Light Wood Veneer



Black Faux Raffia/
Light Wood Veneer

Standard Conrad Vanity Knobs: TRENTON (KB52)



Antiqued Brass



Antiqued
Nickel



Nickel



Polished Brass

Drawer Closing Mechanism: Soft-Close



MADE GOODS

Sizes & Dimensions:

28" POWDER ROOM VANITY

Base w/ Countertop: 28"L x 22"W x 34"H

Base Only: 28"L x 22"W x 33"H

Back Opening: 14"W x 11"H

Bottom Opening to Floor: 15"H

of Drawers: 3

Drawer Heights: 8"H/9"H/9"H

of Knobs: 6

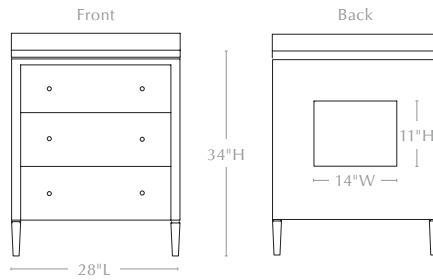

36" SINGLE VANITY

Base w/ Countertop: 36"L x 24"W x 34"H

Base Only: 36"L x 24"W x 33"H

Back Opening: 14"W x 11"H

Bottom Opening to Floor: 15"H

of Drawers: 3

Drawer Heights: 8"H/9"H/9"H

of Knobs: 6

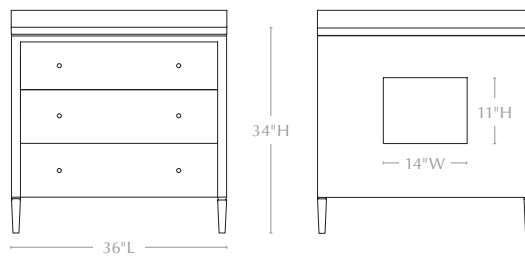

48" SINGLE VANITY

Base w/ Countertop: 48"L x 24"W x 34"H

Base Only: 48"L x 24"W x 33"H

Back Opening: 14"W x 11"H

Bottom Opening to Floor: 15"H

of Drawers: 3

Drawer Heights: 8"H/9"H/9"H

of Knobs: 6

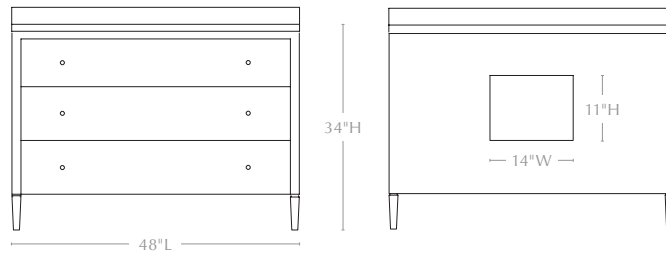

60" DOUBLE VANITY

Base w/ Countertop: 60"L x 24"W x 34"H

Base Only: 60"L x 24"W x 33"H

Back Openings: 14"W x 11"H

Bottom Opening to Floor: 15"H

of Drawers: 6

Drawer Heights: 8"H/9"H/9"H

of Knobs: 12

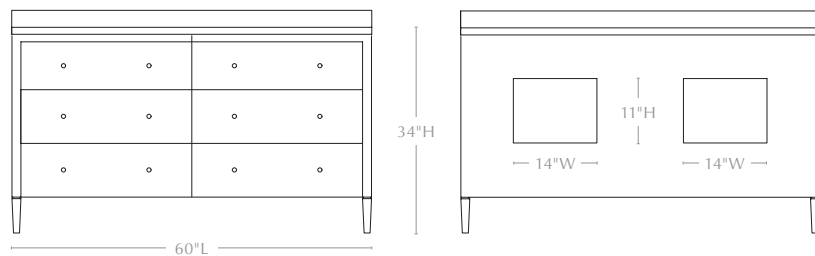

72" DOUBLE VANITY

Base w/ Countertop: 72"L x 24"W x 34"H

Base Only: 72"L x 24"W x 33"H

Back Openings: 14"W x 11"H

Bottom Opening to Floor: 15"H

of Drawers: 6

Drawer Heights: 8"H/9"H/9"H

of Knobs: 12

