



MADE GOODS

AMARA FREESTANDING VANITY

Standing atop tapered legs with elegant rounded corners, our freestanding Amara vanity exudes a refined touch. Naturally occurring irregular grain patterns of poplar burl add character, while stunning caned panel doors open to roomy, soft-close drawers. Brass knobs feature a textured pattern to complement the burl. Due to the handmade nature of this piece, variation is to be expected.



Vanity Base/Drawer Interior:



Dark Stained Poplar Burl/
Dark Wood Vanner

Standard Amara Vanity Knobs: OXFORD (KB10)



Antiqued Brass



Antiqued
Nickel



Nickel



Shiny Brass

Drawer Closing Mechanism: Soft-Close



MADE GOODS

Sizes & Dimensions:

28" POWDER ROOM VANITY

Base w/ Countertop: 28"L x 22"W x 34"H
Base Only: 27.21"L x 21.61"W x 33"H
Back Opening: 14"W x 11"H
Bottom Opening to Floor: 15"H
of Drawers: 2
Drawer Heights: 5.5"H/6.1"H
of Knobs: 2

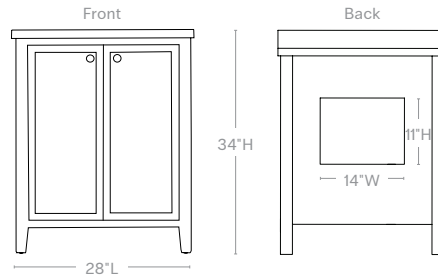

36" SINGLE VANITY

Base w/ Countertop: 36"L x 24"W x 34"H
Base Only: 35.21"L x 23.61"W x 33"H
Back Opening: 14"W x 11"H
Bottom Opening to Floor: 15"H
of Drawers: 2
Drawer Heights: 5.5"H/6.1"H
of Knobs: 2

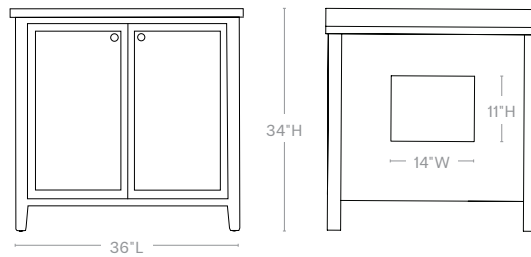

48" SINGLE VANITY

Base w/ Countertop: 48"L x 24"W x 34"H
Base Only: 47.21"L x 23.61"W x 33"H
Back Opening: 14"W x 11"H
Bottom Opening to Floor: 15"H
of Drawers: 2
Drawer Heights: 5.5"H/6.1"H
of Knobs: 2

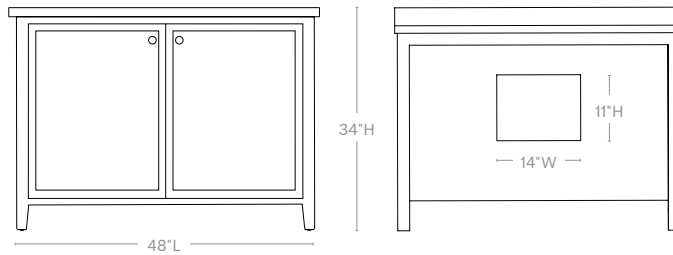

60" DOUBLE VANITY

Base w/ Countertop: 60"L x 24"W x 34"H
Base Only: 59.21"L x 23.61"W x 33"H
Back Openings: 14"W x 11"H
Bottom Opening to Floor: 15"H
of Drawers: 4
Drawer Heights: 5.5"H/6.1"H
of Knobs: 4

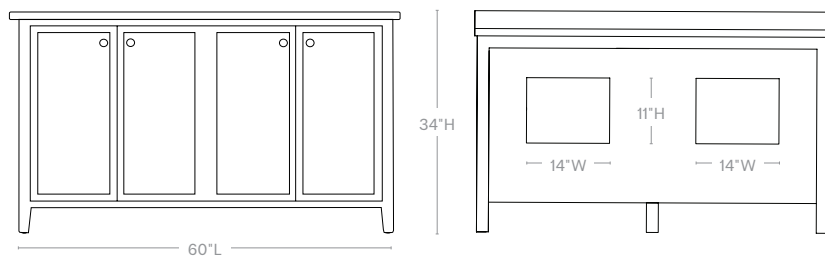

72" DOUBLE VANITY

Base w/ Countertop: 72"L x 24"W x 34"H
Base Only: 71.21"L x 23.61"W x 33"H
Back Openings: 14"W x 11"H
Bottom Opening to Floor: 15"H
of Drawers: 4
Drawer Heights: 5.5"H/6.1"H
of Knobs: 4

